

- LIST OF IRISH WATER STANDARD DETAILS BROUGHT INTO THE CONTRACT
- STD-W-04 GENERAL PIPE CONNECTIONS (SHEET 1 OF 7)
 - STD-W-05 GENERAL PIPE CONNECTIONS (SHEET 2 OF 7)
 - STD-W-06 GENERAL PIPE CONNECTIONS (SHEET 3 OF 7)
 - STD-W-07 GENERAL PIPE CONNECTIONS (SHEET 4 OF 7)
 - STD-W-08 GENERAL PIPE CONNECTIONS (SHEET 5 OF 7)
 - STD-W-09 GENERAL PIPE CONNECTIONS (SHEET 6 OF 7)
 - STD-W-10 GENERAL PIPE CONNECTIONS (SHEET 7 OF 7)
 - STD-W-11 TYPICAL SERVICE LAYOUT INDICATING SEPARATION DISTANCES
 - STD-W-12 RESTRICTIONS ON TREES / SHRUBS PLANTING ADJACENT TO WATERMAIN
 - STD-W-13 TRENCH BACKFILL & BEDDING
 - STD-W-14 SLUCE VALVE FOR DUCTILE IRON (D.I.) PIPE (<350MM DIA.) (SHEET 1 OF 2)
 - STD-W-15 SLUCE VALVE FOR POLYETHYLENE (P.E.) PIPE (<350MM DIA.) (SHEET 2 OF 2)
 - STD-W-16 ON-LINE HYDRANT FOR DUCTILE IRON (D.I.) PIPE (SHEET 1 OF 4)
 - STD-W-17 OFF-LINE HYDRANT FOR DUCTILE IRON (D.I.) PIPE(SHEET 2 OF 4)
 - STD-W-18 ON-LINE HYDRANT FOR POLYETHYLENE (P.E.) PIPE(SHEET 3 OF 4)
 - STD-W-19 OFF-LINE HYDRANT FOR POLYETHYLENE (P.E.) PIPE(SHEET 4 OF 4)
 - STD-W-20 ON-LINE AIR VALVE FOR DUCTILE IRON (D.I.) PIPE(SHEET 1 OF 4)
 - STD-W-21 OFF-LINE AIR VALVE FOR DUCTILE IRON (D.I.) PIPE(SHEET 2 OF 4)
 - STD-W-22 ON-LINE AIR VALVE FOR POLYETHYLENE (P.E.) PIPE(SHEET 3 OF 4)
 - STD-W-23 OFF-LINE AIR VALVE FOR POLYETHYLENE (P.E.) PIPE(SHEET 4 OF 4)
 - STD-W-24 PRESSURE REDUCING / SUSTAINING VALVE(P.R.V./P.S.V.) CHAMBER
 - STD-W-26 METER CHAMBER (<300MM DIA.)
 - STD-W-27 MARKER POSTS / PLATES
 - STD-W-28 WATER MAIN THRUST & SUPPORT BLOCKS
 - STD-W-30 SCOUR CHAMBER & HEAD WALL ARRANGEMENTS
 - STD-W-30A WASHOUT HYDRANT
 - STD-W-31 TYPICAL DITCH / STREAM CROSSING FOR WATER MAIN

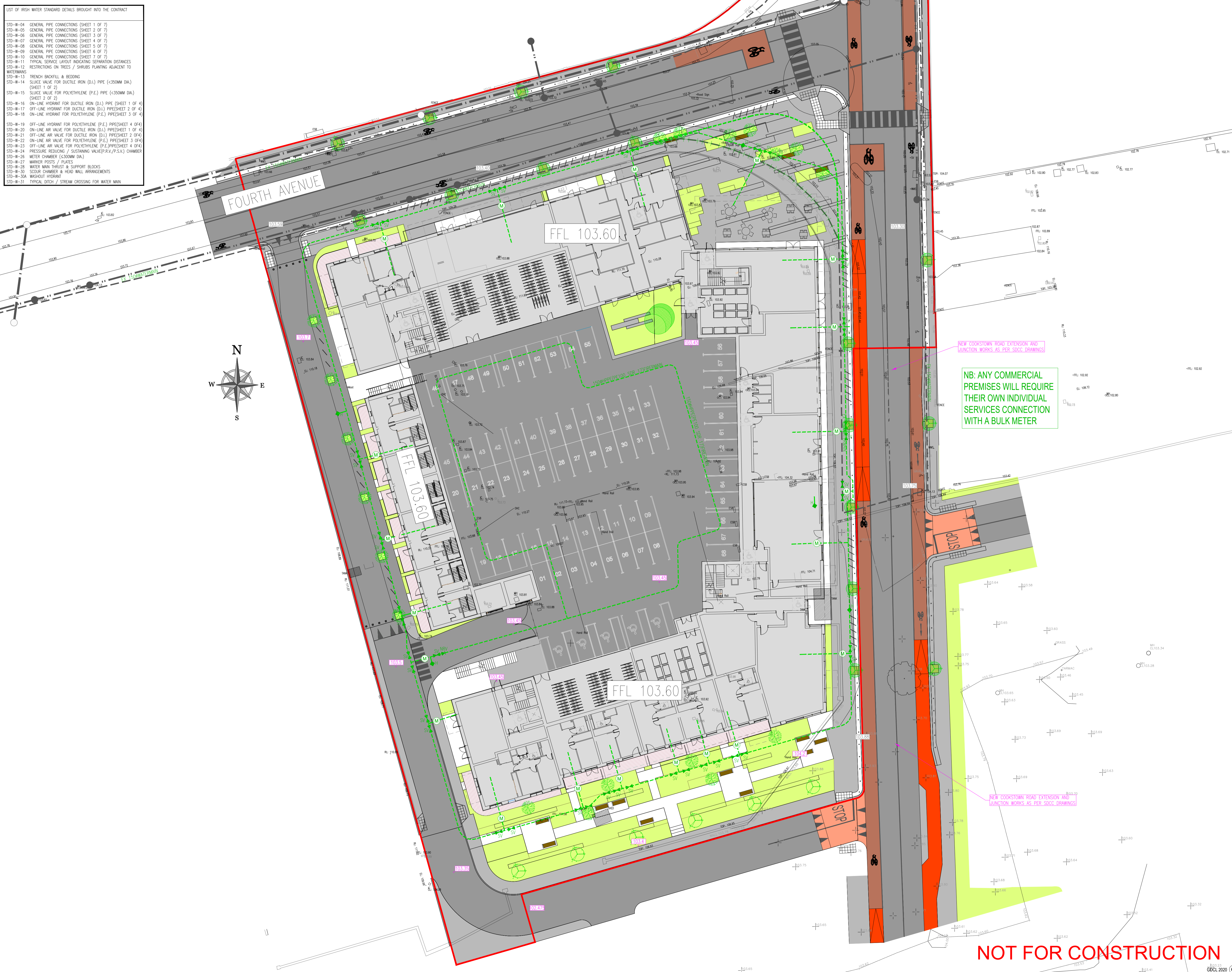

NB: ANY COMMERCIAL PREMISES WILL REQUIRE THEIR OWN INDIVIDUAL SERVICES CONNECTION WITH A BULK METER

- NOTES
1. ALL DRAWINGS TO BE CHECKED BY CONTRACTOR ON SITE AND ENGINEER INFORMED OF DISCREPANCIES BEFORE WORK COMMENCES
 2. ALL LEVELS ARE IN METRES AND ARE RELATED TO ORDNANCE DATUM
 3. CONTRACTOR SHALL SATISFY HIMSELF AS TO THE ACCURACY OF PAVEMENT LEVELS ON SITE PRIOR TO COMMENCEMENT OF WORKS ON SITE
 4. ALL SURFACE WATER DRAINAGE WORKS TO BE IN ACCORDANCE WITH THE REQUIREMENTS OF THE LOCAL AUTHORITY'S CODE OF PRACTICE FOR DRAINAGE AND THE GOODS
 5. ALL SURFACE WATER SEWERS TO BE CLASS H CONCRETE TO EN1916 & IS 6 2004.
 6. ALL FOUL DRAINAGE WORKS TO BE IN ACCORDANCE WITH IRISH WATER'S CODE OF PRACTICE FOR WASTEWATER SUPPLY AND WASTEWATER INFRASTRUCTURE STANDARD DETAILS.
 7. FOUL SEWERS TO BE THERMOPLASTIC STRUCTURED WALL PIPES (COMPLYING WITH THE PROVISION OF IS EN 13476 AND WS 4-35-01 2000) AND COMPLY WITH THE REQUIREMENTS OF THE IRISH WATER CODE OF PRACTICE.
 8. WATERMAIN INSTALLATION AND ALL WATER SUPPLY WORKS TO BE IN ACCORDANCE WITH THE REQUIREMENTS OF IRISH WATER'S CODE OF PRACTICE FOR WATER SUPPLY AND WATER INFRASTRUCTURE STANDARD DETAILS.
 9. WATERMANS TO BE TYPE HPPE, PE-100, SDR-17 RATED AND SHALL CONFORM TO IS EN 12201 (PART 1, PART 2 & PART 3).
 10. WATERMAIN SERVICE CONNECTION PIPES TO BE HDPE (PE-80) MATERIAL WITH SDR-17 RATING.
 11. ANCHOR BLOCKS TO BE POSITIONED AT DEAD ENDS, TEES, BENDS AND AT EACH SIDE OF HYDRANTS AND VALVES IN ACCORDANCE WITH THE REQUIREMENTS OF IRISH WATER STANDARD DETAIL STD-W-28 (WATER MAIN THRUST AND SUPPORT BLOCKS).
 12. HYDRANT OUTLET TO BE 200mm BELOW GROUND LEVEL UNLESS REQUESTED OTHERWISE.
 13. WHERE COVER TO PIPE IS LESS THAN 900mm IN GREEN AREAS AND 1200mm IN TRAFFICKED AREAS, ENCASE PIPE IN NEW 150mm CONCRETE WITH MOVEMENT JOINTS.
 14. RISING MAIN TO BE POLYETHYLENE PIPE AND FITTINGS FOR WASTEWATER SHALL COMPLY WITH THE REQUIREMENTS OF IS EN 12201

LEGEND

	PROPOSED HPPE(PE100 SDR 17) WATERMAIN
	SLUCE VALVES AS PER IRISH WATER STANDARD DETAIL STD-W-14/15
	HYDRANTS AS PER IRISH WATER STANDARD DETAIL STD-W-16/18
	AIR VALVE AS PER IRISH WATER STANDARD DETAIL STD-W-20/22
	SCOUR VALVE AS PER IRISH WATER STANDARD DETAIL STD-W-30
	METER CHAMBERS AS PER IRISH WATER STANDARD STD-W-26
	PROPOSED BOUNDARY BOX AND HDPE SERVICE CONNECTION (PE80 SDR 17)
	EXISTING WATERMAIN TO BE DECOMMISSIONED
	EXISTING SPOT/ROAD LEVEL
	PROPOSED ROAD/SPOT LEVEL
	EXISTING FOUL SEWER
	EXISTING SURFACE WATER SEWER
	EXISTING WATERMAIN
	PROPOSED BUILDING
	PROPOSED ROADWAY
	PROPOSED FOOTPATH

Rev	Date	Description	By	CHK
P6	01/10/20	PLANNING (ABP)	PTC	GD
P5	09/10/19	PLANNING (ABP)	SM	GD
P4	17/09/19	ISSUED TO IRISH WATER	SM	GD
P3	16/09/19	ISSUED TO IRISH WATER	SM	GD
P2	13/09/19	ISSUED TO IRISH WATER	SM	GD
P1	21/08/19	LAYOUT / SCHEME REVISED	PTC	GD
P	05/09/18	REVISED LAYOUT / APPLICATION	PTC	GD

PLANNING

gdcl
CONSULTING ENGINEERS

Scope House, 75 Shelton Street, Covent Garden, London WC2H 9JQ
Dublin D12 K8PP www.gdclconsulting.com

PROJECT
Cookstown Cross, Fourth Avenue
Cookstown Industrial Estate

CLIENT
Steelworks Property
Developments Limited

DRAWING TITLE
Watermain Layout

dm. by: PTC	date: JUL 16	scale: 1:250
drawing size: A1	chk: TM	app: GD
job no: P-1606	drg. no: P-1606-C-102	rev: P6

NOT FOR CONSTRUCTION